



EN

JP

KO

THAI

VT

ZT

PT

ES

X3

Quick Start Guide

Packing List



X3 (x1)



Power Adapter (x1)



Quick Start Guide (x1)



Power Cable (x1)



Network Cable (x1)



HDD Rubber Case 1 (Optional) (x2)
(For 7mm thick HDD)



HDD Rubber Case 2 (Optional) (x2)
(For 9mm thick HDD)



- The HDD rubber case will not be included if the product is equipped with a HDD by default.
- The figures in this manual are for reference only and may differ from the actual product.

Appearance

Front Panel

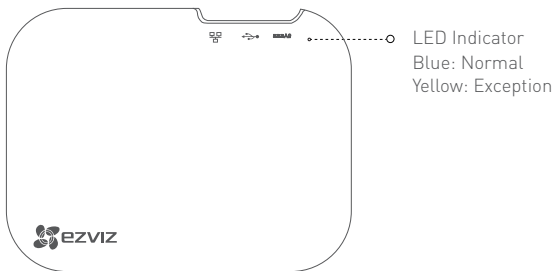

Interface Part 1

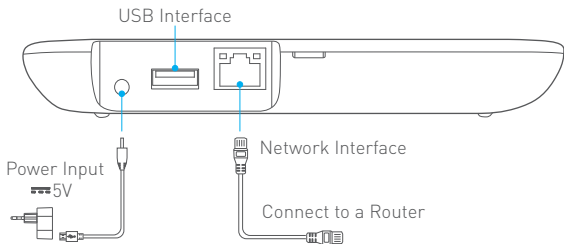

- i** The network cable is not included in the package. It should be prepared separately.

Interface Part 2



To reset the settings: Press and hold the RESET button with a needle for as least 3 seconds when the device is power-on, and release until the LED indicator flickers quickly.

2.5-inch HDD Installation (Optional)

1 Loosening the Screws

Loosen the 4 screws on the base of the X3 with a screwdriver, as shown in the figure below:

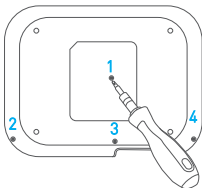

i The No.1 screw is behind the label.

2 Opening the Cover

Open the cover at the groove according to the direction of arrow, as shown in the figure below:

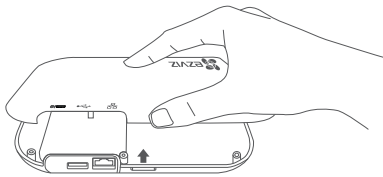

3 Installing the HDD Rubber Case

Pick an appropriate rubber case according to the HDD thick, and cover the rubber case on the two sides of the HDD, as shown in the figure below.

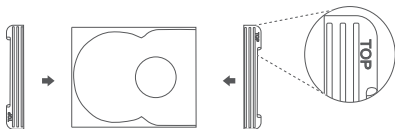

i If the HDD is 9mm thick, the TOP mark of the rubber case should be facing upward when installing .

4 Installing the HDD

Connect the HDD cable to the HDD and place the HDD in the designated position, as shown in the figure below.

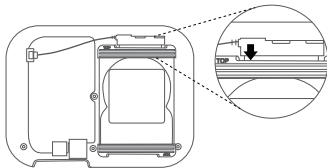

5 Completing Installation

Replace the cover and fasten the 4 screws in the step 1 and complete the installation.

Operations

Step 1

Starting up the X3

1 Connecting to the Network

Connect X3 to the router with a network cable.

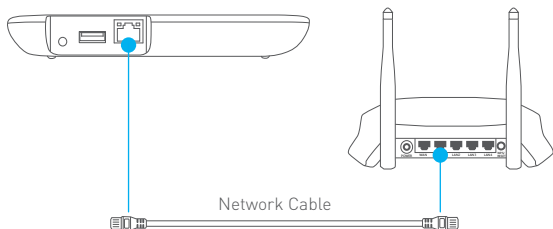

i The X3 does not support the Wi-Fi network connection.

2 Power-on

Connect the X3 to the power adapter with a power cable, and connect to the power socket. The LED indicator turns solid blue when the X3 starts completely.

i The indicator turns solid yellow in the following cases:

- No installed HDD
- HDD error
- Device exceptions

Step 2

Adding Devices to EZVIZ



1 Installing the EZVIZ App

- Download and install the EZVIZ app by searching the “EZVIZ” in App Store or Google Play™.
- Launch the app and register for an EZVIZ user account.

2 Adding X3 to EZVIZ

- Log into the EZVIZ app.
- Click the “+” on the upper-right hand corner to add a device.
- Scan the QR Code on the bottom of X3.

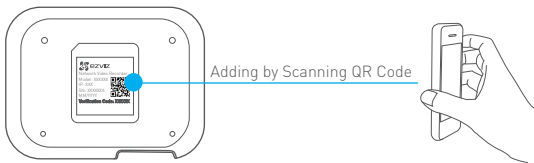

3 Adding Network Camera to EZVIZ

The procedure of adding a network camera is the same as the adding X3. Refer to the step 2 to add a network camera to your EZVIZ account.

Step 3

Completing Configuration

After adding the X3 and cameras to your EZVIZ account, go to the storage status of camera and enable the X3 recording. X3 will start the 7*24-hours continuous recording of cameras.

- i** The X3 supports up to 8 cameras recording.

Function Introduction



7*24-hour continuous cycle recording and playback.



Unique HDD Storage Technology

The unique disk pre-allocation technology is able to extend the HDD lifetime, effectively decrease the disk fragments, increase the HDD utilization, and ensure the video security.



EZVIZ Cloud Service

Cloud recording videos and pictures.



Certain functions of this product (including but not limited to live view, recording, and remote playback) depend upon the Internet connection. To learn more about these functions, visit the EZVIZ website ezvizlife.com and register for a new account.